

Inventory list: Salona 44 (2012)



Name: Neda I

- Year: 2012
- LOA: 13,50 m
- Beam: 4,19 m
- Draft: 2,55 m
- Main sail area: 50,02 m²
- Genoa sail area: 42,78 m²
- Engine: Yanmar 54 hp
- Fuel type: Diesel
- Consumption: 6 l/h
- Water tank: 400 lit.
- Fuel tank: 250 lit.
- Cabins: 4 + salon
- Berths: 8 + 2
- Toilet/Shower: 2

DECK EQUIPMENT	NAVIGATION	OTHER
<ul style="list-style-type: none"> ▪ Full battened main sail ▪ Roll genoa ▪ Bow thruster ▪ Bimini top ▪ Sprayhood ▪ Electric anchor windlass ▪ Steering wheel x 2 ▪ Cockpit table ▪ Cockpit loudspeaker ▪ Cockpit shower ▪ Dinghy/oars/pump ▪ Main anchor + 50 m chain ▪ Second anchor/chain/rope ▪ Emergency tiller ▪ Mooring ropes ▪ Fenders ▪ Boathook ▪ Gangway ▪ Teak in cockpit 	<ul style="list-style-type: none"> ▪ Autopilot ▪ Log/speed instrument ▪ Windex ▪ VHF Radio ▪ GPS-plotter ▪ Harbour guides ▪ Navigation charts ▪ Main compass ▪ Hand-held compass ▪ Binoculars 	<ul style="list-style-type: none"> ▪ Hot water ▪ Gas oven ▪ Electric refrigerator ▪ Kitchen inventory ▪ Aditional gas bottle ▪ Tuner/CD player ▪ TV ▪ Battery charger ▪ Shore connection 220 V ▪ 12 V on board ▪ Safety equipment ▪ First aid kit ▪ Heating (cabins + saloon) ▪ Liferaft

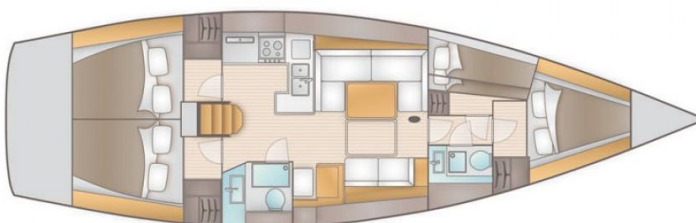

- Salona 44 layout

- Checkin:
Saturday 18:00 h
- Checkout:
Saturday 08:00 h
- Departure base:
Split